

A-dec Inspire® Sterilization Center



Content Map	1
Operate / Adjust	2
Clean / Maintain	13
Specifications	17

Copyright

© 2022 A-dec, Inc. All rights reserved.

A-dec, Inc. makes no warranty of any kind with regard to this material, including, but not limited to, the implied warranties of merchantability and fitness for a particular purpose. A-dec, Inc. shall not be held liable for any errors contained herein or any consequential or other damages concerning the furnishing, performance or use of this material. The information in this document is subject to change without notice. If you find any problems in the documentation, please report them to us in writing. A-dec, Inc. does not warrant that this document is error-free.

No part of this document may be copied, reproduced, altered, or transmitted in any form or by any means, electronic or mechanical, including photocopying, recording, or by any information storage and retrieval system, without prior written permission from A-dec, Inc.

Trademarks and Additional Intellectual Property Rights

None of the trademarks or trade names in this document may be reproduced, copied, or manipulated in any manner without the express, written approval of the trademark owner.

A-dec, the A-dec logo, A-dec Inspire, Cascade, Century Plus, Continental, Decade, ICX, ICV, Performer, Preference, Preference Collection, Preference ICC, Radius, and reliablecreativesolutions are trademarks of A-dec, Inc. and are registered in the United States and other countries. A-dec 500, A-dec 400, A-dec 300, A-dec 200, ICX Renew, ICX Restore, and EasyFlex are also trademarks of A-dec, Inc.

In the United States, Pozidriv is a registered trademark of Phillips Screw Company, Purell is a registered trademark of GOJO Industries Inc., Bon Ami is a registered trademark of Bon Ami Company, Comet is a registered trademark of KIK International LLC, Fantastic is a registered trademark of S.C. Johnson & Son, Inc., Formula 409 and SOS are registered trademarks of The Clorox Company, Scotch-Brite is a registered trademark of 3M Company, and Soft Scrub is a registered trademark of Henkel Consumer Goods Inc. These may also be trademarks or registered trademarks in other countries.

All other trademarks followed by ® are registered trademarks of A-dec, Inc. in the United States and may also be trademarks or registered trademarks in other countries.

Certain touchpad symbols and icons are proprietary to A-dec, Inc. Any use of these symbols or icons, in whole or in part, without the express written consent of A-dec, Inc., is strictly prohibited.

Regulatory Information and Warranty

For required regulatory information and the A-dec warranty, see the *Regulatory Information, Specifications, and Warranty* document (p/n 86.0221.00) available in the Resource Center at www.a-dec.com.

Product Service

Product service is available through your local authorized A-dec dealer. For service information, or to locate an authorized dealer, contact A-dec at 1.800.547.1883 in the USA and Canada or 1.503.538.7478 worldwide, or visit www.a-dec.com.

Product Models and Versions Covered in This Document

Models	Versions	Description
594	A	Sterilization Center

The features and options shown in this document may not be available for all models of A-dec Inspire. For more information about the options included with your configuration, contact your authorized A-dec dealer.

Video Support Icon



Topics noted with this icon are supported with supplemental video. Click on the icon to open the video directly in YouTube. For additional user support materials, go to www.a-dec.com/InspireSupport.

Content Map

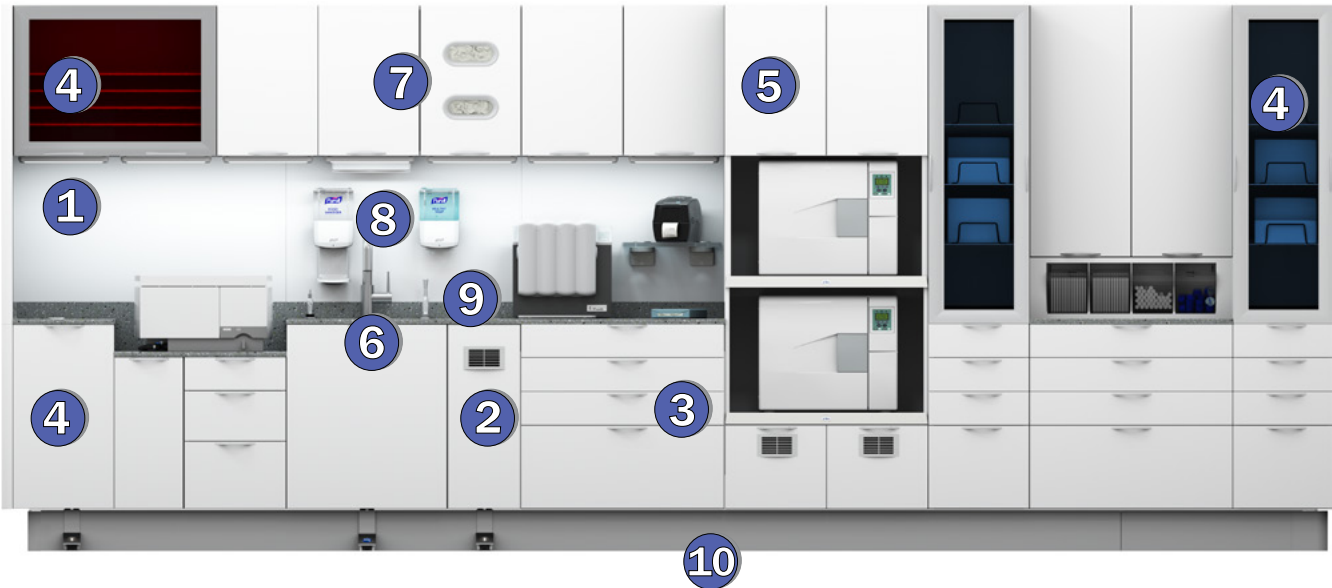

Topics

- [1](#) Task Light 2
- [2](#) Instrument Dryer 2
- [3](#) Drawer/Shelf Adjustments 3
- [4](#) Power-Assisted Drawers and Doors 6
- [5](#) Remove and Adjust Doors 7
- [6](#) Sink Module 10
- [7](#) Glove and Towel Dispensers 11
- [8](#) Soap/Hand Sanitizer Dispenser Refill 12
- [9](#) Surface Management 13
- [10](#) Remove/Install Base Covers ... 15

Main Sections

- Operate / Adjust 2
- Clean / Maintain 13
- Specifications 17

Note. Click on any number to go to that topic.

Operate / Adjust

Task Light Switch



Use the rocker switch to turn the task lights on and off. This switch will control all of the sterilization center task lights, whether you have a straight, corner, or galley configuration.

Instrument Dryer

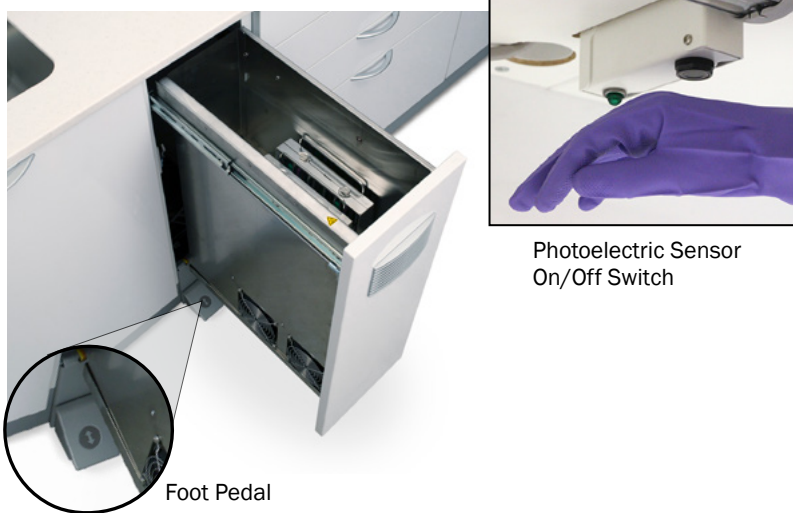

Press the instrument dryer foot pedal to open or close the dryer. To start the dryer, wave your hand under the photoelectric sensor located on the upper cabinet. The green light blinks while the dryer is running. When the drying cycle ends, the green light turns solid.

If you open the door during the drying cycle, the dryer will stop and the green light will turn off. Close the door to reset the cycle. The cycle runs for about 14 minutes.



WARNING The contents and surrounding metal surfaces will be hot when the drying cycle ends or is interrupted. Wait for the dryer to cool completely before removing any items.

Remove and Adjust Drawers/Shelves

Insert Drawer



Storage Drawer

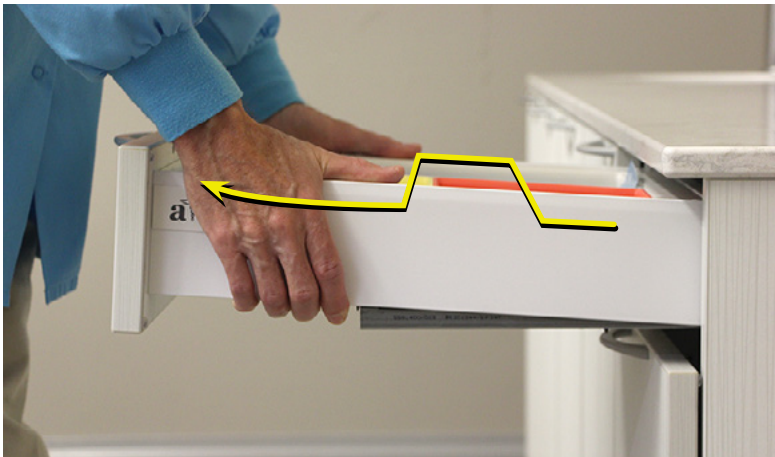

Remove a Drawer or Shelf

All of the drawers and shelves remove for easy access to wiring and utilities or to retrieve anything that may have fallen behind the drawers. To accommodate a variety of applications, A-dec Inspire includes several different drawer styles, each constructed with slightly different hardware.

Drawer/Shelf Style	Removal Method
Insert Drawer	Press in the orange tabs and lift out.
Storage Drawer	Pull out, lift up, then pull out and down.



WARNING Do not attempt to remove the upper blue storage pullout drawers. They are heavy and may cause injury if not properly supported when removed. If you need to remove them, contact your authorized A-dec dealer for assistance.

Adjust Drawer Face Alignment



CAUTION To avoid damaging the screws, use a #2 Pozidriv® screwdriver to adjust the screws that move the drawer face.

Storage drawers include adjustment screws on both sides of the drawer to correct drawer face alignment. To access the screws, remove the A-dec cover. The screw furthest from the drawer face adjusts up and down alignment. The screw closest to the drawer face adjusts side-to-side alignment.

Up and Down Alignment

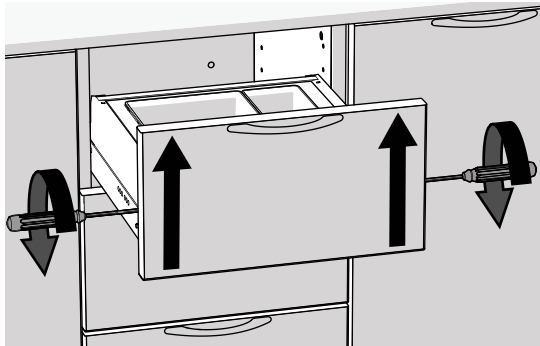

Each side can be adjusted independently.

For up-and-down alignment:

1. Remove the A-dec cover.
2. On the left side, turn the screw counterclockwise to raise the drawer face or clockwise to lower the drawer face.

On the right side, turn the screw clockwise to raise the drawer face or counterclockwise to lower the drawer face.

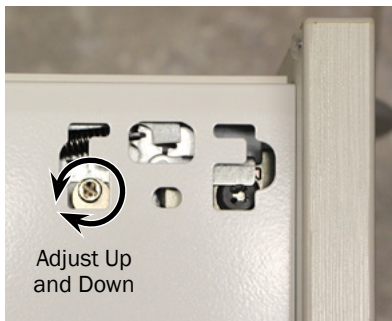

Left Side of Drawer



Right Side of Drawer

Adjust Drawer Face Alignment *(cont.)*

Side-to-Side Alignment

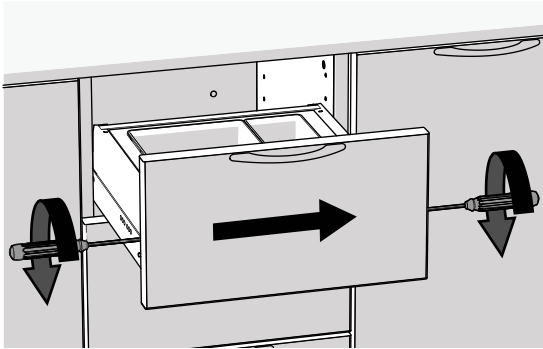

Adjust both sides
at the same time.



Adjust Side
to Side

Left Side of Drawer



Adjust Side
to Side

Right Side of Drawer



CAUTION To avoid damaging the screws, use a #2 Pozidriv screwdriver to adjust the screws that move the drawer face.

For side-to-side alignment:

1. Remove the A-dec cover.
2. On the left side, turn the screw counterclockwise to move the drawer face right or clockwise to move the drawer face left.
3. On the right side, turn the screw the same number of increments, but clockwise to move the drawer face right or counterclockwise to move the drawer face left.



NOTE Make sure to turn the left- and right-hand screws in equal increments. To simplify the adjustment, adjust both sides at the same time.

Power-Assisted Drawers and Doors



Waste Storage Drawer

A slight bump with your knee or hip will open the power-assisted waste storage drawer, so you won't have to put anything down to access the waste containers.

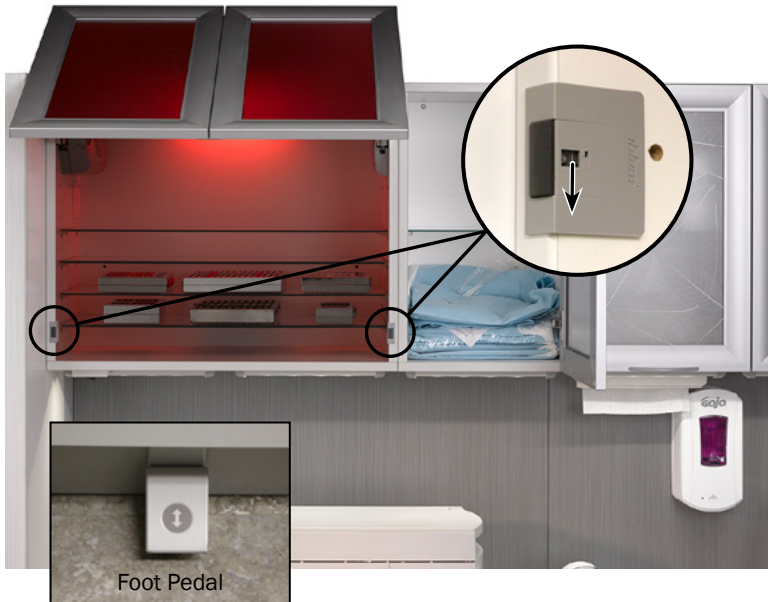

Red Upper Storage Door



CAUTION Stand clear while operating the door. The pressure sensitive servo that opens and closes the door helps minimize – but does not eliminate – the possibility of injury.

To operate the power-assisted red upper storage door, use the remote foot pedal or press lightly on the right- or left-lower corner.

Wireless Sensors

If either of the two front sensors stops working, the battery may be low and require replacement. To remove the battery, push the clear plastic tab on the sensor down and pull the black tab out.

If the door no longer opens or closes with the foot-activation pedal, contact your authorized A-dec dealer for service.

Power-Assisted Drawers and Doors (cont.)

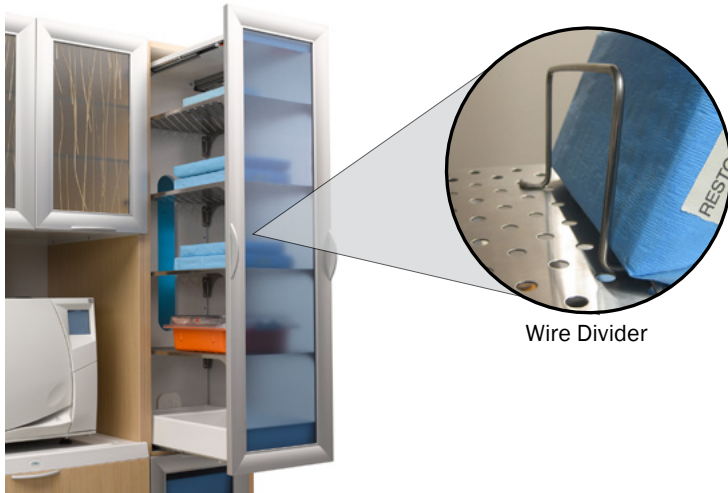

Blue Storage Pullout

To access the blue storage shelves, use your elbow or hand to bump the upper drawer, or your knee to bump the lower drawer. A servo unit pushes the drawer out for easy access.

Wire Dividers

Use the wire dividers to customize cassette organization. To move a divider, push against the end that curves down and remove from the shelf. Install in the reverse, inserting the end that curves up first. For the proper fit, install the ends two rows apart.

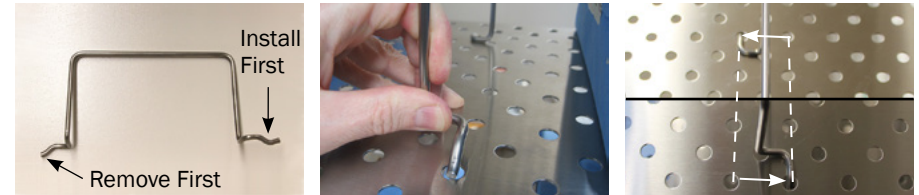

Remove and Adjust Doors

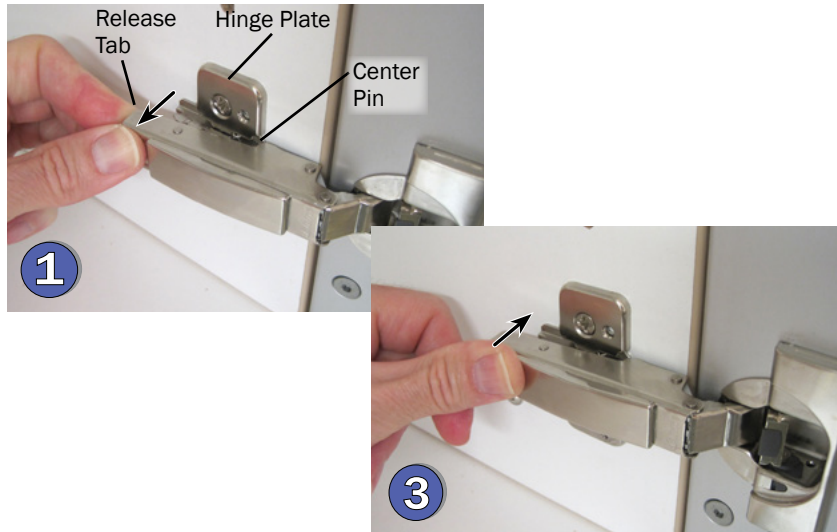

Remove Door

Door hinges include a quick-release tab for easy removal. Start with the lower hinge and hold on to the door during this procedure:

1. Press the quick release tab and pull the hinge out slightly, leaving the center pin engaged in the hinge plate.
2. Repeat for the upper hinge and carefully remove the door.

To reinstall the doors, start with the upper hinge:

3. Align the center pin with the front of the hinge plate and snap the hinge in place.
4. Swing the door several times to ensure that the hinge is secure.

Remove and Adjust Doors *(cont.)*



Deactivate Soft-Close Feature

You can deactivate the soft-close feature, if desired. To deactivate, slide the black switch toward the cabinet on all hinges for that door.

Rearrange Drawers

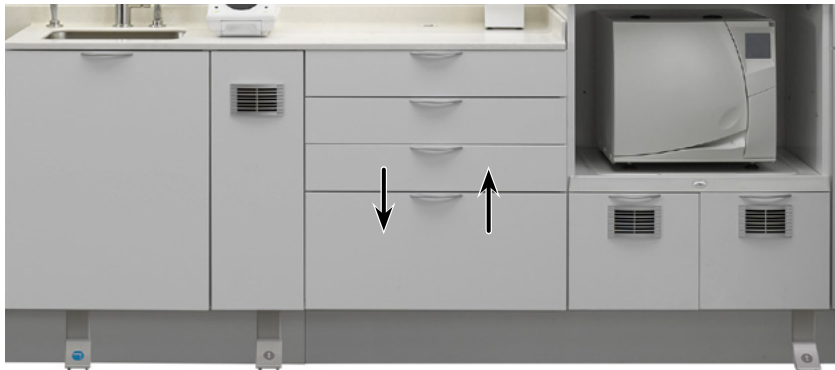

All drawer banks are pre-drilled so the drawers can be rearranged after installation, if required. If you would like to rearrange the configuration of your drawers, contact your authorized A-dec dealer for assistance.

Adjust Hinges/Door Alignment



To adjust the door alignment, remove the hinge cover and follow the guidelines below.

Hinge Cover



CAUTION To avoid damaging the screws, use a #2 Pozidriv screwdriver to adjust the door hinge screws.

Side to Side

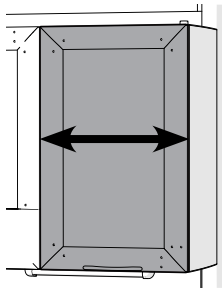

Back to Front

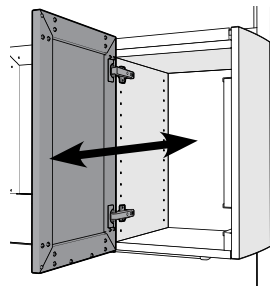

Up and Down

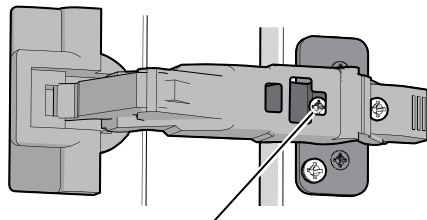
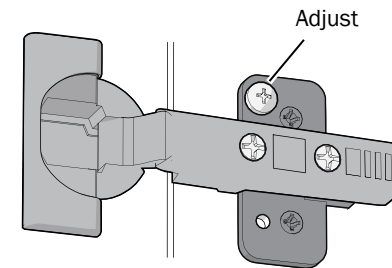
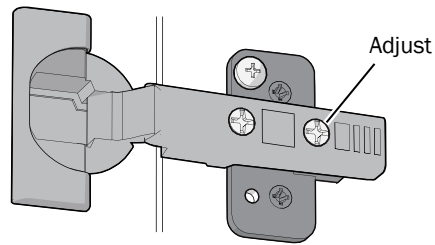
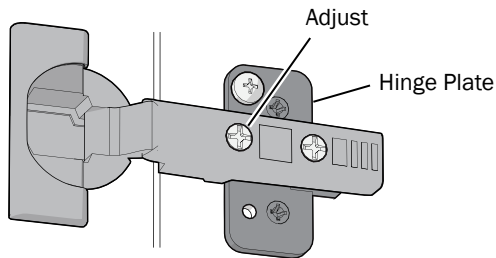
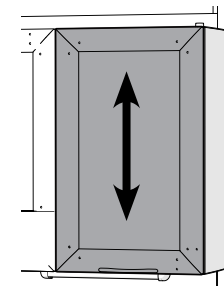

For 155 degree hinges, close the door slightly for better access to the screw.



NOTE The screw on the hinge plate may be at the top or bottom, depending on the door configuration.

Sink Module



Foot-Activated Faucet

All A-dec Inspire sink options include a foot-activated faucet. Water temperature and flow are determined by the faucet handle position. To set, simply press the foot pedal and move the faucet handle until you reach your desired temperature and flow rate.

Air Syringe

The sink module includes an air syringe for purging water from handpieces and attachments.

Glove Shelf

Use the tray inside the sink module as a convenient place to store chemical gloves.

Glove and Towel Dispensers



Order dispenser refills that meet the following specifications:

Product	Dispenser Specification
Glove	9-1/2"L x 5"W x 3"H carton
Paper Towels	9-1/2" x 9-1/4" Z- or Multi-Fold

To ensure that a glove carton is secure in the dispenser, twist the elastic band at least once before looping the end around the dispenser tab.

Soap and Hand Sanitizer Dispensers

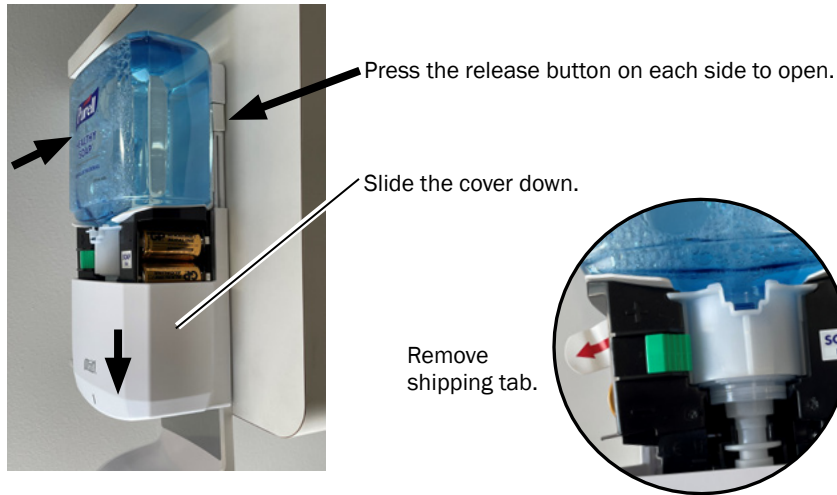

If the auto soap and hand sanitizer dispensers are full, but not working, open the units and ensure that the shipping tabs were removed.

For refills, order the following:

Product	Part Number/Description
Purell® Soap Refill	90.1861.00 2 Pack Refill Kit
Purell® Hand Sanitizer Refill	90.1860.00 2 Pack Refill Kit



Replace the Batteries:

If the indicator light is not flashing and there is soap in the dispenser (and the shipping tab has been removed), replace the batteries.

1. Press the dispenser release buttons and slide the cover down.
2. Insert two new size C alkaline batteries.



NOTE Do not mix old and new batteries.

Clean / Maintain

Surface Management



To preserve your investment, A-dec recommends that you use barriers where possible. Where barriers are not practical, or when cleaning and disinfection are required, use the least harmful EPA-registered disinfectants that can provide the protection you need, while reducing potential harm to the equipment.

No solution is 100 percent safe. But there are choices available today that offer a balance between effective disinfection and minimal impact to your equipment, office staff, and patients. For A-dec Inspire, use the following guidelines – and always follow the cleaner/disinfectant manufacturer's directions for use.

Least Harmful:

- ▶ Barriers
- ▶ EPA-registered disinfecting wipes with:
 - quaternary ammonium chlorides (“quats”) with less than 25% isopropyl alcohol
- ▶ EPA-registered disinfecting sprays with:
 - high-dilution, water-based phenols
- ▶ Mild dishwashing liquid and water (for cleaning only)



Most Harmful:

- ▶ Sodium hypochlorite (bleach)
- ▶ Hydrogen peroxide (pH <4)
- ▶ Isopropyl alcohol (>40%)
- ▶ Products with abrasives (e.g., pumice, calcium carbonate)
- ▶ Abrasive applicators/scrubbers





NOTE In general, disinfecting wipes (when properly used) are less harmful than disinfecting sprays – primarily due to overspray and lack of consistent application. Always follow the disinfectant manufacturer's directions for use.

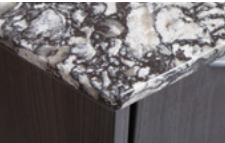

IMPORTANT For a quick reminder of these guidelines, see the *A dec Inspire Asepsis Quick Reference* (p/n 86.0632.00), which was included with your dental furniture order. For more details on cleaning and disinfecting, see the *A-dec Equipment Asepsis Guide* (p/n 85.0696.00), which is available in the Resource Center at www.a-dec.com.

Surface Management *(cont.)*

Surface/Item	Routine Cleaning	Light Stains	Heavy Stains/Scratches/Burns	Do NOT Use
Solid Surface 	Soft cotton cloth with a solution of mild dishwashing liquid and warm water.	Soap and water, glass cleaner, or non-abrasive household cleaners such as Fantastik® and Formula 409®.	Matte finishes only: Apply an abrasive cleaner (such as Comet®, Soft Scrub®, Bon Ami®, etc.), then buff with a purple Scotch-Brite® pad using a circular motion.	Aggressive or oxidizing chemicals. See page 13 for other harmful disinfectants.
Quartz 	Soft cotton cloth with a solution of mild dishwashing liquid and warm water.	Soap and water, glass cleaner, or non-abrasive household cleaners such as Fantastik® and Formula 409®.	Contact A-dec customer service.	Aggressive or oxidizing chemicals, abrasive, strong alkaline, or highly acidic cleaners (such as bleach, Comet®, Soft Scrub®, SOS®, products with pumice, paint removers, furniture strippers, and tarnish, silver, or oven cleaners). See page 13 for other harmful disinfectants.
Laminate Surfaces 	Soft cotton cloth with a solution of mild dishwashing liquid and warm water.	Soap and water, or non-abrasive household cleaner/detergent and a soft bristled brush.	Use a soft bristled brush with a paste of baking soda and water. Lightly scrub for 10-20 seconds.	Aggressive or oxidizing chemicals, bleaching agents, or cleaners containing lye, steel wool, or other abrasives. See page 13 for other harmful disinfectants.
Infills 	Soft cotton cloth with a solution of mild dishwashing liquid and warm water.	Soap and water, glass cleaner, or non-abrasive household cleaners such as Fantastik® and Formula 409®.	Contact A-dec customer service.	Aggressive or oxidizing chemicals. See page 13 for other harmful disinfectants.

Surface Management *(cont.)*

Remove/Install Base Covers

Side Corners

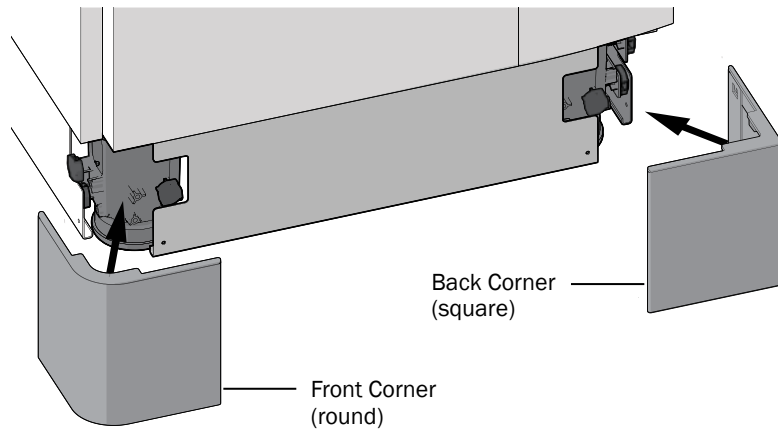

Front/Back Straight Panels

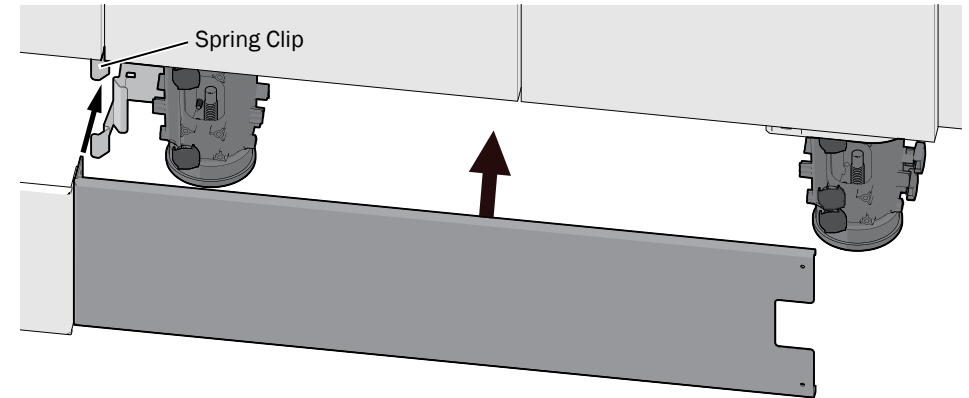

Cabinet base covers are easily removed for cleaning or to access utilities. Pull the covers straight out to remove them. When you reinstall the covers, make sure they attach in their original location onto magnets or inserted into spring clips. Place the rounded corner base covers on the front corners of the cabinet and the square covers on the back corners.







WARNING Do not expose A-dec Inspire surfaces to harsh chemicals or use solvents such as acetone or lacquer thinner. If these chemicals come in contact with the surface, immediately wash them off with water, using appropriate safety measures to avoid injury.



CAUTION Base covers are held in place with high strength magnets. To avoid pinching fingers when removing or installing the base covers, hold the base cover by the edges.

Common Replacement Items

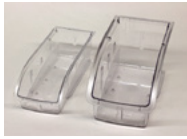
Contact your authorized A-dec dealer for available A-dec Inspire replacement items.

Item/Description	Part Number
Interchangeable Drawer Bins  	57.0135.01 white 57.0134.01 blue 57.0133.01 red 57.0132.01 yellow
Insert Drawer Bins 	57.0142.01 14" Wrapping Drawer 57.0146.01 14" Make Ready Drawer 57.0147.01 28" Make Ready Drawer 57.0143.01 28" Wrapping Drawer 90.1484.00 14" Soaking Drawer w/Lid
Hanging Bins 	042.754.00 Hanging Bin, Clear, Large 042.754.01 Hanging Bin, Clear, Medium 042.754.02 Hanging Bin, Clear, Small 042.755.00 Hanging Bin, Div, Clear, Large 042.755.01 Hanging Bin, Div, Clear, Medium 042.755.02 Hanging Bin, Div, Clear, Small 042.761.00 Hanging Bin, Side Div, Clear, Small
Purell® Soap Refill 	90.1861.00 pkg of 2
Purell® Hand Sanitizer Refill 	90.1860.00 pkg of 2

Specifications



IMPORTANT For electrical specifications, identification of symbols, and other regulatory requirements, see the *Regulatory Information, Specifications, and Warranty* document (p/n 86.0221.00) available in the Resource Center at www.a-dec.com.



NOTE Specifications are subject to change without notice. Requirements may vary depending on your location. For more information, contact your authorized A-dec dealer.



 **A-dec Headquarters**

2601 Crestview Drive
Newberg, OR 97132 USA
Tel: 1.800.547.1883 Within USA/CAN
Tel: 1.503.538.7478 Outside USA/CAN
Fax: 1.503.538.0276
www.a-dec.com

A-dec Australia

Unit 8
5-9 Ricketty Street
Mascot, NSW 2020
Australia
Tel: 1.800.225.010 within AUS
Tel: +61.(0).2.8332.4000 outside AUS

A-dec China

A-dec (Hangzhou) Dental Equipment Co., Ltd.
Building 5, No. 528 Shunfeng Road
Tangqi Town, Yuhang District
Hangzhou, Zhejiang, China 311100
Tel: 400.600.5434 within China
Tel: +86.571.89026088 outside China

A-dec United Kingdom

11 Liberty Way
Nuneaton, Warwickshire CV11 6RZ
England
Tel: 0800.ADEC.UK (2332.85) within UK
Tel: +44.(0).24.7635.0901 outside UK



86.0527.00 Rev C
Date of Issue 2022-05-12
Copyright 2022 A-dec, Inc.
All rights reserved.